

DJS

Property Consultants

Exceptional Value

To Let – First Floor Serviced Offices Sandbeck Way, Wetherby, LS22 7DN

Location

The premises are situated on Sandbeck Way which lies on the outskirts of Wetherby. Sandbeck Way is a popular business location which has attracted a number of significant national and regional occupiers and offers superb access to the A1 and Wetherby Town Centre both of which are approximately ½ mile distant.

Description

Self-contained Office suites are available and include the following facilities:

- Central heating
- Suspended ceilings with recessed lighting
- Carpeted throughout
- Male and female toilets and kitchen facility
- On-site car parking

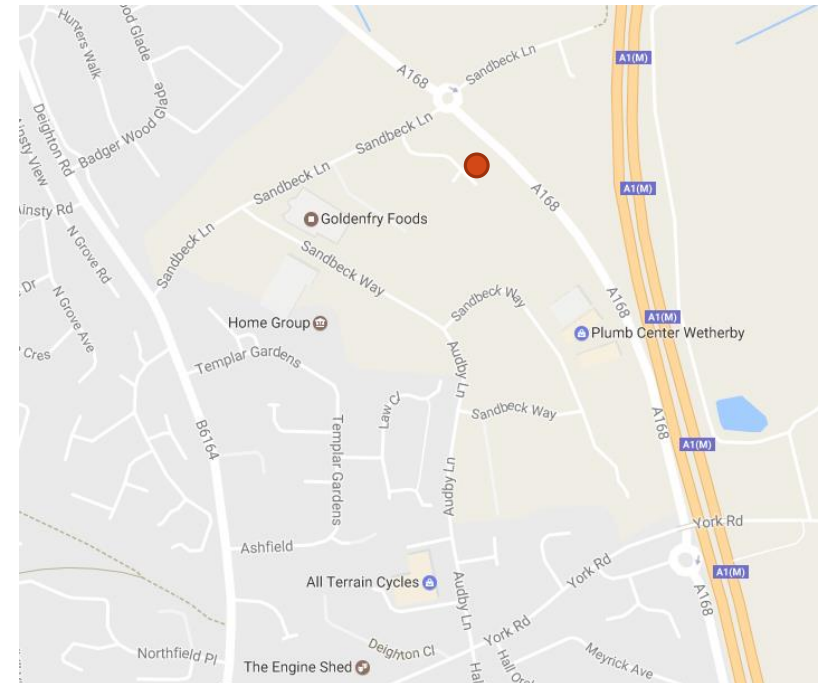

DJS

Property Consultants

Office suites available

Office Number	Area (SqM)	Area (SqFt)	Rent (PCM)
1	13.10	140	£200.00
2	18.17	195	£230.00
3	30.97	333	£465.00
4	17.35	186	£270.00
5	17.58	189	£264.00
6	21.35	230	£324.00
7	30.66	330	£462.00

Terms

Each office is to be occupied under license for a minimum period of 6 months. License fees are paid monthly in advance. Each party is to be responsible for their own costs in relation to the licence agreement. Further information on request.

Should you require further information or wish to make an appointment to inspect please contact: David Smith

Mobile: 07733 895928

Email: david@djsproperty.co.uk

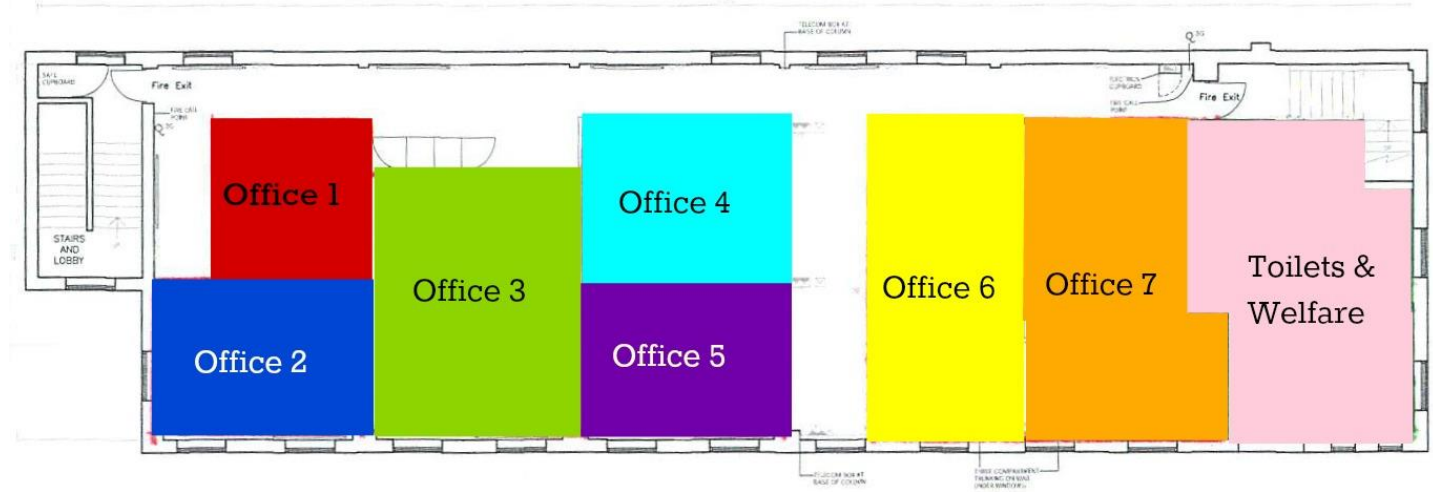

Areas shown in white are common areas.

Services

Monthly rents include heating, lighting, WIFI and business rates. Cleaning of common areas and toilet accommodation is also included.

Optional Services – Office desk and chair and dedicated internet (at extra cost).