

## Exceptional Value

## To Let – First Floor Serviced Offices Sandbeck Way, Wetherby, LS22 7DN



### Location

The premises are situated on Sandbeck Way which lies on the outskirts of Wetherby. Sandbeck Way is a popular business location which has attracted a number of significant national and regional occupiers and offers superb access to the A1 and Wetherby Town Centre both of which are approximately ½ mile distant.

### Description

Self-contained Office suites are available and include the following facilities:

- Central heating
- Suspended ceilings with recessed lighting
- Carpeted throughout
- Male and female toilets and kitchen facility
- On-site car parking

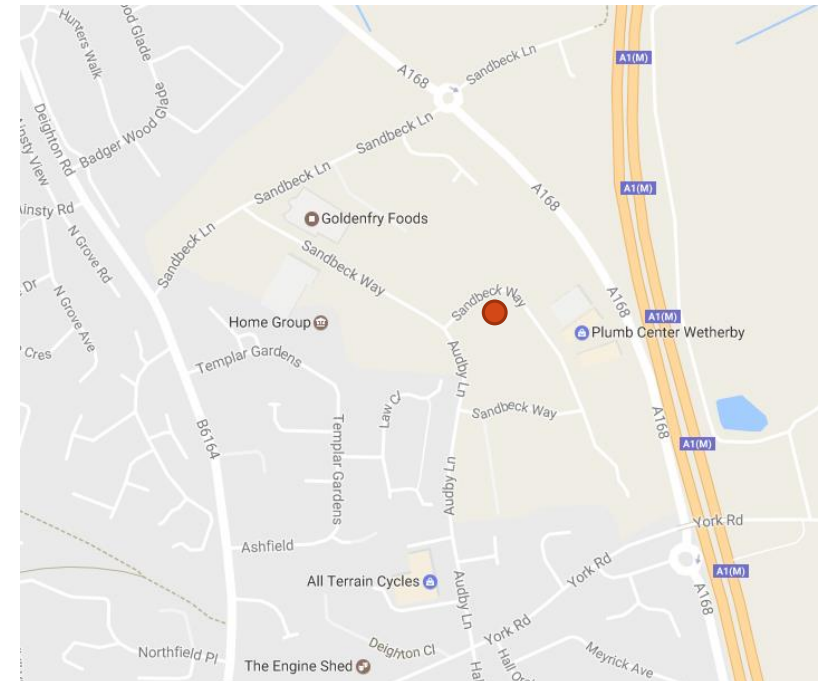

## Office suites available

Office Number	Area (SqM)	Area (SqFt)	Rent (PCM)
1	13.10	140	£200.00
2	18.17	195	£230.00
3	30.97	333	£465.00
4	17.35	186	£270.00
5	17.58	189	£264.00
6	21.35	230	£324.00
7	30.66	330	£462.00

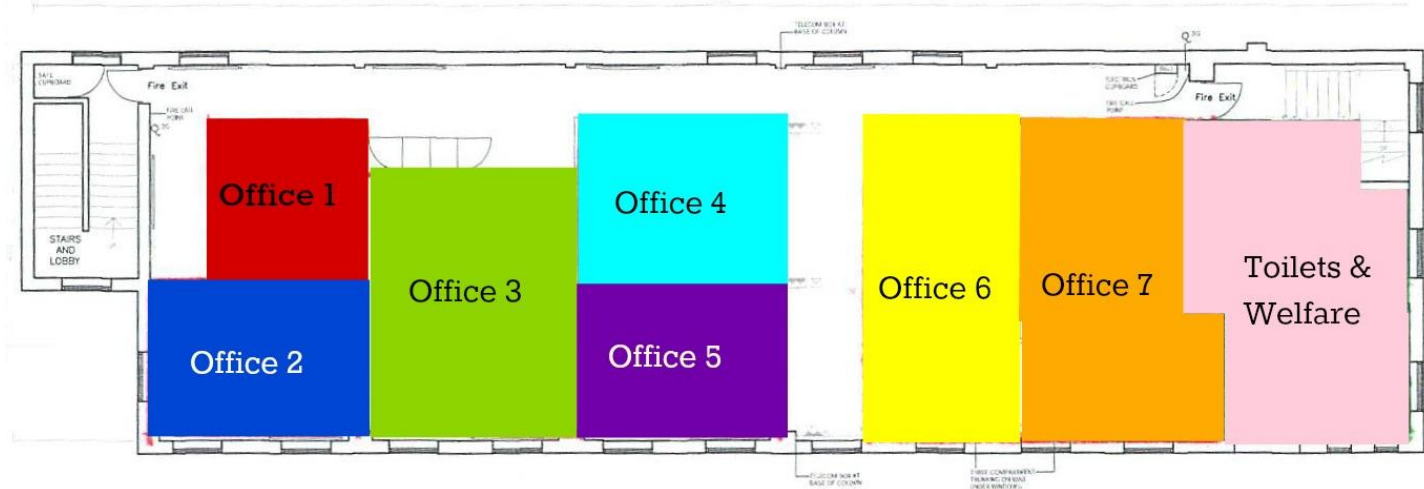

Areas shown in white are common areas.

### Services

Monthly rents include heating, lighting, WIFI and business rates. Cleaning of common areas and toilet accommodation is also included.

**Optional Services** – Office desk and chair and dedicated internet (at extra cost).

### Terms

Each office is to be occupied under license for a minimum period of 6 months. License fees are paid monthly in advance. Each party is to be responsible for their own costs in relation to the licence agreement. Further information on request.

**Should you require further information or wish to make an appointment to inspect please contact: David Smith**

**Tel: 0113 826 7685**

**Mobile: 07733 895928**

**Email: david@djsproperty.co.uk**

Notice relating to misrepresentation: DJS Surveyors Ltd on its/their behalf and for the sellers or lessors of this property whose agents they are give notice that (1) the particulars are set out as a general outline only for the guidance of intending purchasers or lessees, and do not constitute, nor constitute part of, an offer or contract (2) All descriptions, dimensions, references to condition and necessary permissions for use and occupation and other details are given in good faith and are believed to be correct, but any intending purchasers or tenants should not rely on them as statements or representations of fact, but must satisfy themselves by inspection or otherwise as to the correctness of each of them (3) no person employed by DJS surveyors Ltd has any authority to make or give any representation or warranty in relation to this property unless otherwise stated. (4) prices and rents quoted are exclusive of vat.